

Wire Free Door Chime

No wiring is required for this Wireless Door Chime. When the push button is pressed it sends a wire free signal to the door chime that activates the chime. Since the operating range is up to 100m (unobstructed) you can position your door chime virtually anywhere in the home, workshop and office. However, the transmission range of the wire free signal will be reduced if the signal is transmitted through a number of walls or ceilings. Metal and UPVC door frames will also reduce the operating range.

Battery Installation - Push button unit (fig1, fig2)

1. Push button unit is operated by a 1 x 3 volt CR2032 Lithium battery (included).
2. The Lithium battery (CR2032) has been installed, it is ready to use by pulling out the plastic strip.

Replace the batteries (fig1, fig2)

- a. Remove the back of the case by pushing in the tab on the bottom with a small, flat screw driver.
- b. Remove the locking screw from the battery fastener of the battery compartment.
- c. Insert 1 x 3 volt Lithium battery (CR2032 - included) into the battery compartment ensuring the battery polarity matches the internal markings.
- d. Snap the front cover of the push button back on.

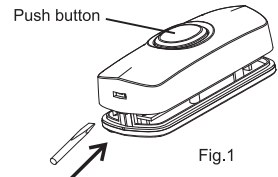

Fig.1

Use flat screw driver to push the hole, to open the cover

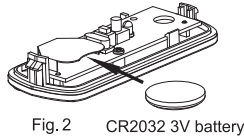

Fig.2 CR2032 3V battery

Installation Guide - Push button unit (fig 3)

Using the two holes on the back of the push button as a template, mark the fixing position for the unit. Drill holes and fit wall plugs and secure the bell push unit in position with 2 x 16mm self tapping screws, or by the double-sided self adhesive pad (included), onto your front door or position nearby.

Important: mounting the push button unit on UPVC door frames or a metal surface will reduce the broadcasting range.

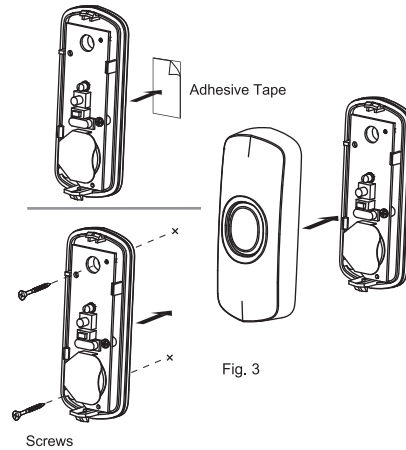

Fig. 3

Battery Installation - Portable Door chime unit (fig 4)

1. Remove the battery cover from the back of the unit by sliding it away from the unit
2. Insert 3 x 1.5v alkaline batteries ("AA", UM3 & LR6 - not included) into the battery compartment, ensuring the battery polarity matches the internal markings.
3. Close the battery door, then the chime unit is ready to use.
4. Test to ensure the door chime unit is located within the operating range before installation.

Installation Guide - Portable Door Chime Unit (Fig 4)

It has a slotted hanging hole on the rear of the unit, this will enable the chime unit to be hooked onto a screw and easily removed or relocated to another room. drill a hole and fit the wall plug (if fixing to masonry) and screw (self tapping 1 x 16 mm screw) to fixing position. Leave a gap of 3 mm between the screw head and the wall. locate the key hole slot on the back of the unit over the screw.

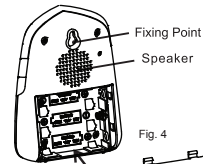
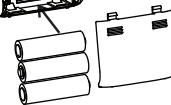

Fig. 4



Removable Battery Cover
(Requires 3x1.5V AA Battery)
(not included)

Operation

When the push button is pressed it sends a wireless signal to the door chime and it will sound. The sound will stop as soon as the melody ends. For repeat sound, press the button again. Holding the button in will NOT repeat the sound.

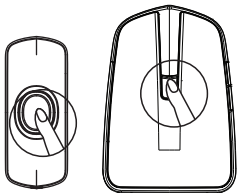

Fig. 5

Pairing (fig 5)

Press and hold the pairing button for 5 seconds until you hear a double beep and then release, then press the bell push until you hear a single beep and then release. Wait for around 20 seconds until you hear another double beep.

Tone / Melody Selection (fig 6)

To select the required tone, press the music selection / pairing button until you reach the required tone / melody.

Volume Control (fig 6)

Adjust the volume by pressing the volume control on the receiver unit.

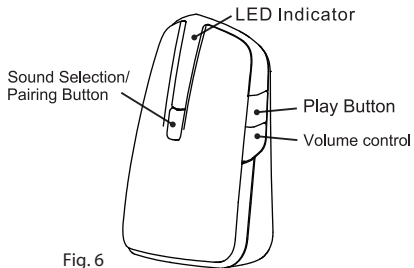

Fig. 6

Important

1. If mounted on to any metal or UPVC door frame, this will reduce the operating range.
2. Do not immerse either unit in water.
3. Do not mount either unit close to a fireplace or expose to high temperature.
4. The door chime unit is designed for indoor use only.
5. Do not leave discharged batteries in the push button units.
6. Always use Alkaline batteries as these will give longer service and are less likely to leak.
7. Batteries should be inserted in the correct polarity.
8. Batteries should be removed and replaced by an adult only.
9. Dispose of batteries safely.
10. Do not attempt to burn batteries.
11. Use collection points for batteries where possible.
12. Make sure that no naked flame sources, such as lit candles, are placed on the unit.
13. Do not use the door chime unit in damp or wet conditions.
14. **CAUTION:** Only batteries of the same or equivalent type as recommended should be used.
15. If leaving the door chime for long periods of time, remove the batteries from the compartment to prevent leakage.
16. If the door chime unit is damaged do not use.

Trouble Shooting & User Hints

| Problem | Possible Causes | Suggested Remedy |
|--|--|---|
| Chime does not sound | <ol style="list-style-type: none">1. Units are out of range (max range 100m)2. No charge in the bell push3. No charge in the door chime unit4. Wrong polarity of batteries in bell push | <ol style="list-style-type: none">1. Operate the Chime unit within the operating range2. Change the battery3. Replace the chime unit batteries4. Re-insert battery in correct polarity |
| Chime sounds without Push Button being pressed | A similar Wire Free Door Chime product is operating nearby on the same frequency digital code | Pair the bell push and door chime again |

Important: There are no user serviceable parts in the unit; do not attempt to repair it.

Specification

A. Push Button Unit

Power : 1 x 3 volt CR2032 Lithium battery (included)
Consumption : 3mA-ON
0.003mA - OFF

B. Wire Free Door Chime Unit

Power : 3 x 1.5 volt ("AA", UM3 & LR6 - not supplied)
Operating temperature : -10°C to +40°C
Operating Distance : 100 metres (328 ft. approx unobstructed)
Selectable tone : 32 melodies

Type R2 device - device where the sound output is created by the initial operation of the control and where the period of sound output continues for designed duration irrespective of condition of the control.



For electrical goods sold within the European Community. At the end of the products useful life, it should not be disposed of with household waste. Please recycle where facilities exist. Check with your Local Authority or retailer for recycling advice.



STATUS INTERNATIONAL (UK) LTD,
PENNINE HOUSE, MORTIMER STREET,
BD19 5AR.